



Instructivo Cajones EuroSoft



www.grupoeurosa.com

ARG	marketing@grupoeurosa.com
ECU	ventasecuador@grupoeurosa.com +593991539019
USA	sales@eurogroupna.us 305-770-4005 +19544771156

Instructivo Cajones EuroSoft



IMPORTANTE: dimensiones expresadas en milímetros (superior) y en pulgadas (inferior) - P. ej.: 37.5 mm / 1 1/2" inches/pulg
IMPORTANT: dimension are expressed both in millimeters (above) and in inches (below) - E.G.: 1 1/2" inches/pulg

EUROSOFT LATERAL CAJÓN DOBLE PARED EUROSOFT DOUBLE WALL DRAWER SYSTEM

Corredera baja, altura M | Lower drawer, M height

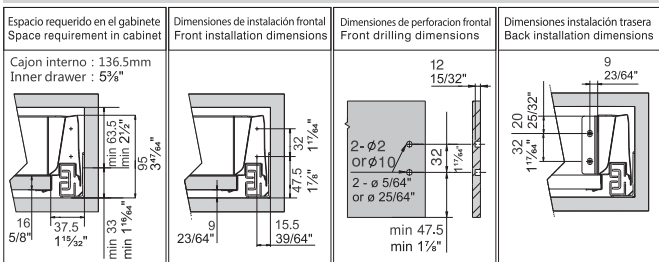

Recorte de dimensiones para placa de hasta 16mm Cutting dimensions for up to 5/8" chipboard

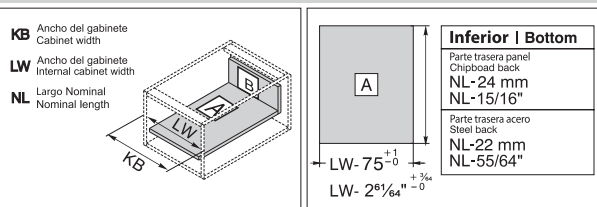

Corredera media, altura B | Medium drawer, B height

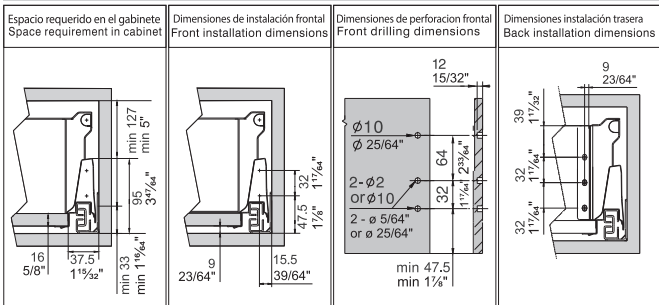

Corredera baja, altura M Lower drawer, M Height

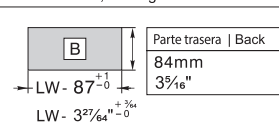

Corredera media, altura B Medium drawer, B Height

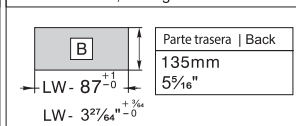

Corredera alta, altura D High drawer, D Height

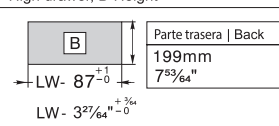

Corredera alta, altura D | High drawer, D height

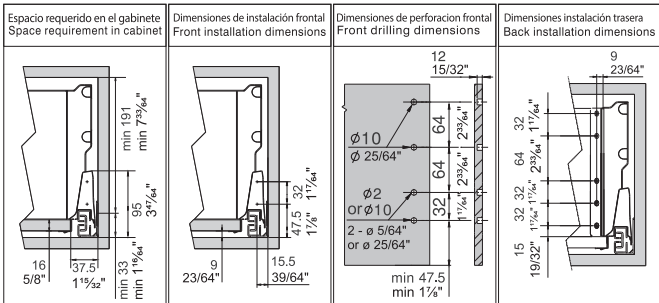

Barra para la sincronización push open Rod for Push-open Synchronization

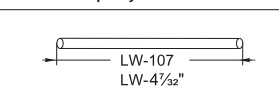

Seccion frontal para cajón interno Front section for inner drawer

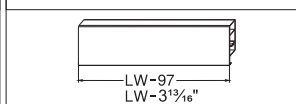

Posición de tornillos cajón interno Push Open Fixing hole for push-open inner drawer

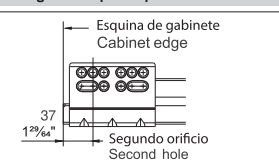

Guardacuerpo frontal cuadrado o redondo Square or round cross rail

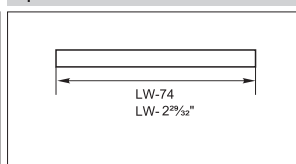

Dimensiones de instalación | Installation dimensions

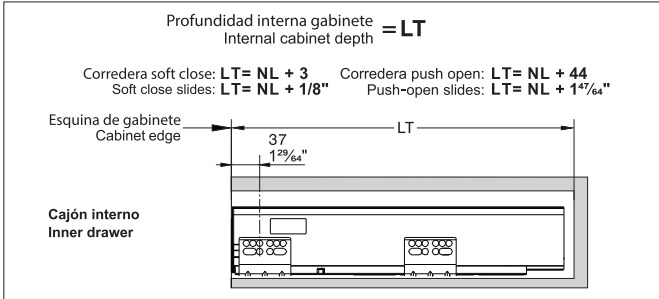
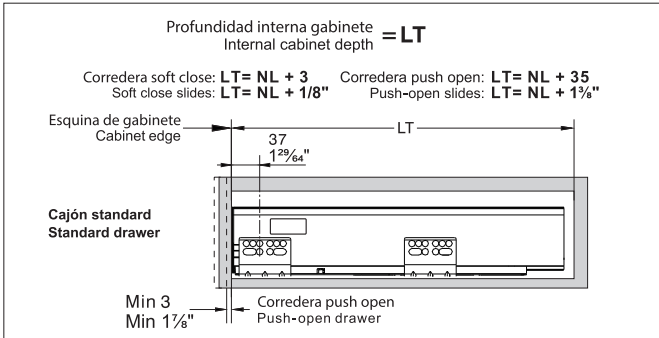

Posición de los tornillos | Slide screws position

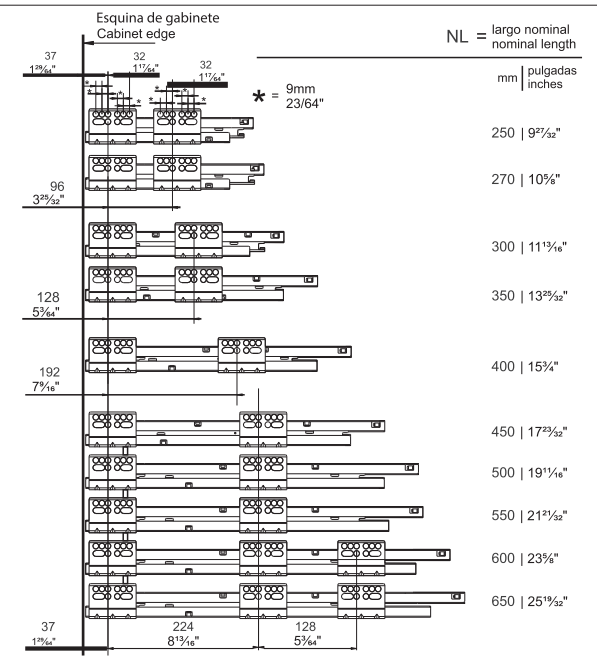

INSTRUCTIVO DE INSTALACIÓN | INSTALLATION INSTRUCTIONS

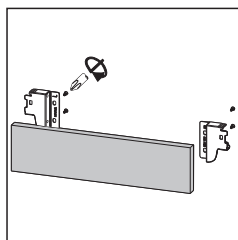

Parte trasera
Back assembly

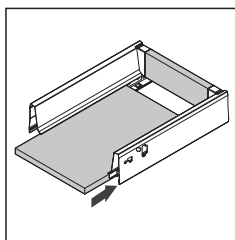
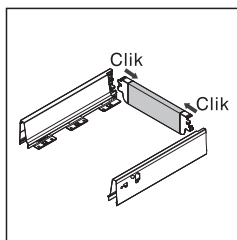

Parte inferior
Bottom assembly

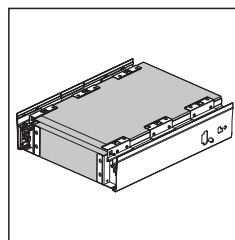

Ajuste tornillos
Fix screws

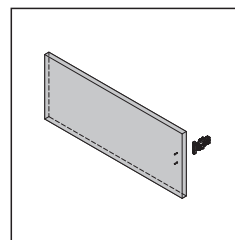

Parte frontal
Front assembly

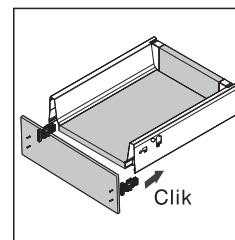

Ajustes | Adjustments

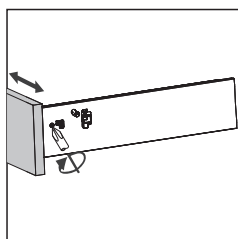

Ajuste derecho e izquierdo
Left & right adjustment

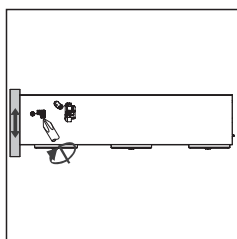

Ajuste arriba y abajo
Up & down adjustment

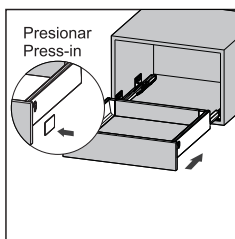

Deslizar dentro del gabinete
Slide into the cabinet

Extraer | How to remove

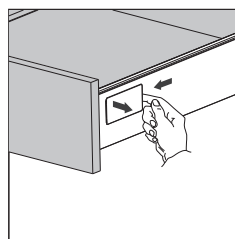

Levantar y quitar la tapa
Tip up the cover and pull out

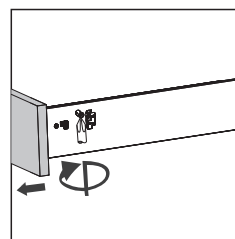

Girar tornillo para liberar
Turn screw to release the
drawer's front

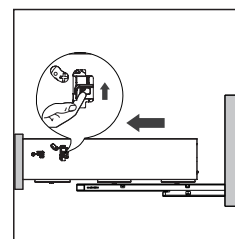

Levantar la manilla y jale
Lift the release handle, hold it
and pull the drawer out

Corredera baja, altura M | Lower drawer, M height

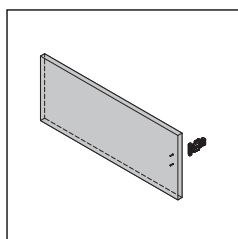

Ensamble frontal
Front panel assembly

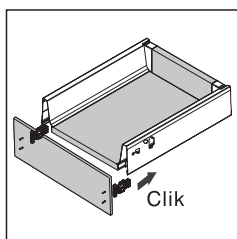

Ensamble trasero
Back panel assembly

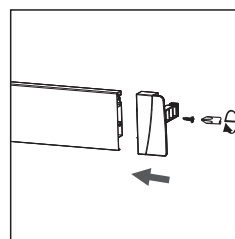

Ensamble frontal
Front panel assembly

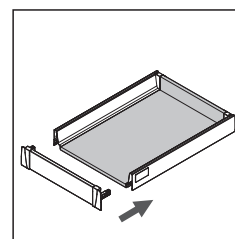

Ensamble trasero
Back panel assembly

Corredera media, altura B | Medium drawer, B height

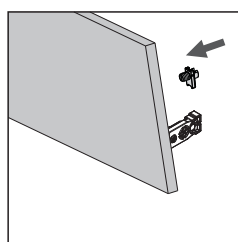

Ensamble frontal
Front panel assembly

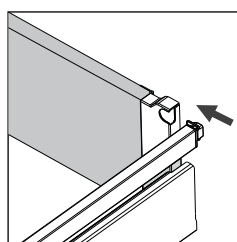

Ensamble trasero
Back panel assembly

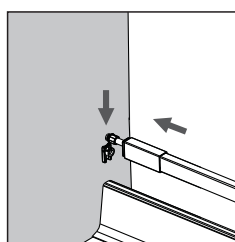

Fijar al panel frontal
Fit to front panel

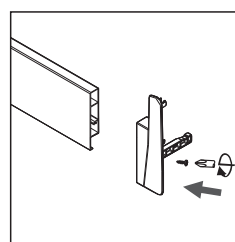

Ensamble frontal
Front panel assembly

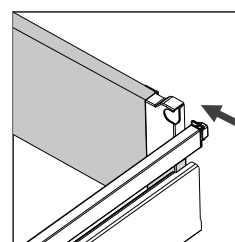

Ensamble trasero
Back panel assembly

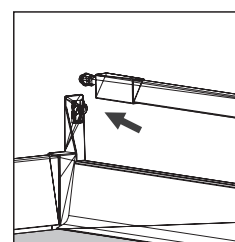

Fijar al panel frontal
Fit to front panel

Corredera alta altura D | High drawer, D height

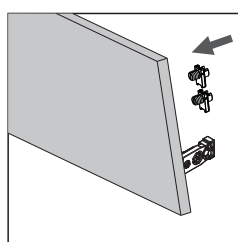

Ensamble frontal
Front panel assembly

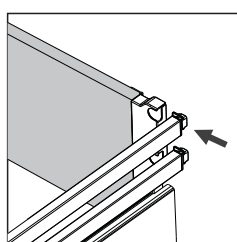

Ensamble trasero
Back panel assembly

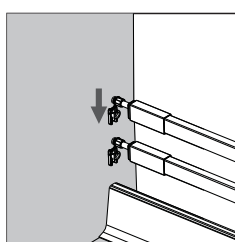

Fijar al panel frontal
Fit to front panel

Corredera alta e interna, altura D | High inner drawer, D height

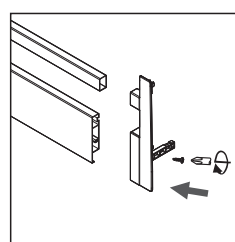

Ensamble frontal
Front panel assembly

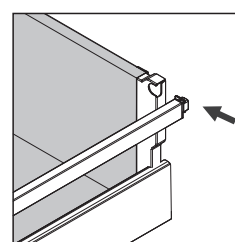

Ensamble trasero
Back panel assembly

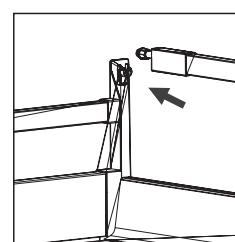

Fijar al panel frontal
Fit to front panel